

Peachcliff Estates, 4505 McLean Creek Rd., OK Falls. It is found by turning left on 10th Ave. after the big intersection, then following 10th Ave. around the right hand curve onto McLean Creek Rd. On the second major curve you will see the entrance to Peachcliff Estates on the right.

This park currently has 159 units in it. There is a new section being developed to the east of the existing park. It will contain 25 more units. Unit G1 in that section has already been sold and has a building on it. This new section will have metered water from the town and will not be on the existing wells.

This park has no Park Reps for P&DMHOA. The Association Newsletter is delivered in the spring and fall, usually April and October.

Peachcliff Estates is a 55+ park. It is owned by Retire West Communities Ltd. The on-site managers are Terry and Beverly Clark. The Office phone number is 250-497-5577.

The park has two wells but only one is used in the winter. The sewer service is through the town system. RDOS does the garbage, recycling and appliance, metal and wood pick-up, so that service has been removed from the monthly pad rent.



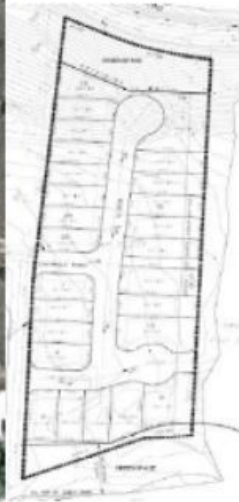

Pad G1 has a unit on it now.

